

Nothing is known of the early history of this site. Two of Llandeilo Graban's yews were described as 'venerable' by the Woolhope society in 1891.

The 1970 Brecon Yew Survey recorded three trees, with girths of 24', 22' and 20' at 5'.

1999: Three male yews grow in a line on the south side of the church. Tree 1 has a partly fluted bole from which 5 main branches and a wealth of smaller material develops above a height of about 5'. Its girth of 26' 1" at the ground included section (A), a leaning branch that is becoming detached from the main tree. Space around the bole was used as a store for grass clippings in 1999, though this had been removed by 2005.

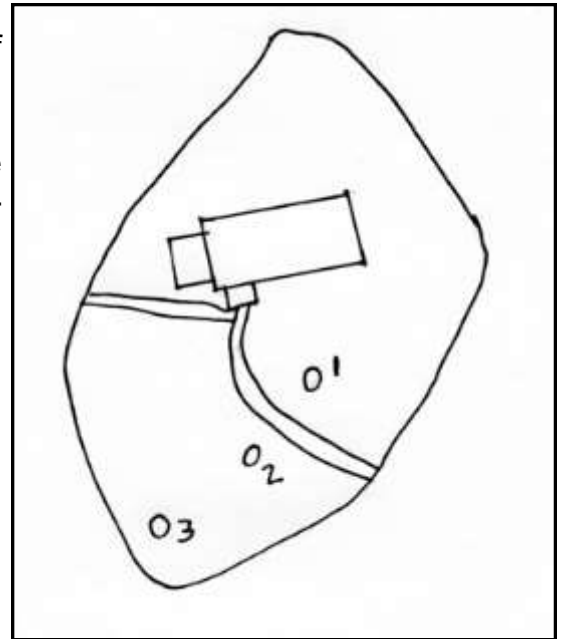
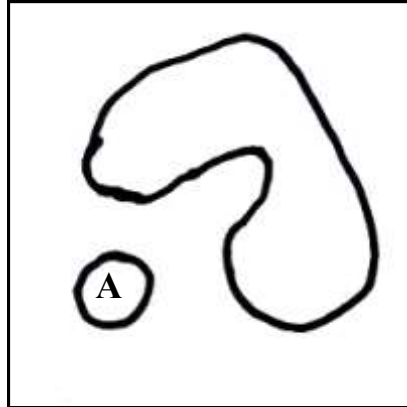

2015: What had changed by the time of Paul Wood's visit 10 years later was the encroachment of ivy over the ground around as well as in the tree. He recorded girth at ground level over the ivy as 26' 6".





Tree 2 grows on a mound. Much of the bole was obscured by ivy which could be seen high into its branches, some of which were dead. Girth was about 18' 6" at or near the base of the tree in 1999, but this figure would be exaggerated because of the thick ivy.

1999 - Tim Hills



1999 - Tim Hills



2004 - Geoff Garlick



When Paul Wood visited in September 2015 ivy filled the ground and grew high into the tree. An ivy inflated girth of 19' 0" was recorded.







Tree 3 grows SSW of the church. It has a bole of 3'4" supporting many branches. Girth was 18' 10" close to the ground in 1999.

photos 2004 - Geoff Garlick



In 2015 (below) Paul Wood recorded that twiggy growth and ivy made it impossible to get close to the tree.



© Tim Hills/Paul Wood - Ancient Yew Group - 2019