

1866: A yew of 12' girth in Aston churchyard, growing in the 'hedgerow above the road', was recorded in the *Woolhope Paper*.

2003: This is the tree described in Woolhope, found on the bank just outside the churchyard boundary wall. Girth at 1', or 7' above the road, was 17' 3". The photos were taken in 2007.



In 2015 Paul Wood recorded a girth of 18' 11" (5.77m) at the same height. Even though this included ivy now starting to cover the bole, it is still a considerable increase.



Inside the churchyard are smaller girthed yews.

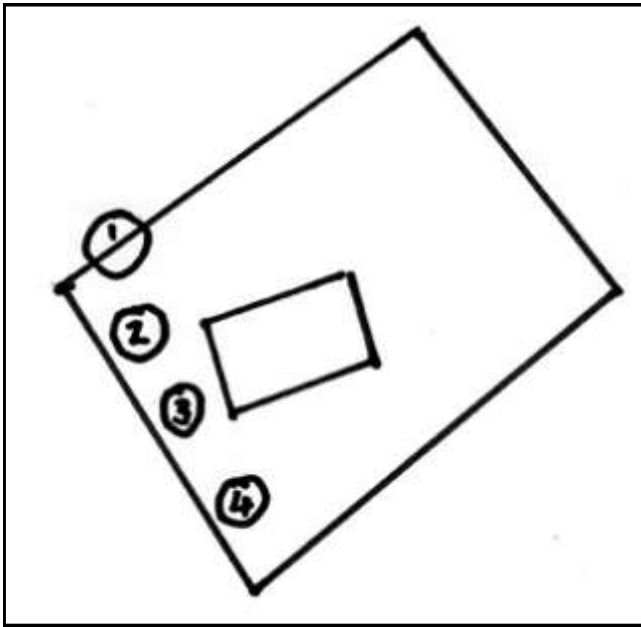

Tree 2 on the plan had a girth of 10' 6" at 3' in 2003. Measured in 2015 by Paul Wood at its visible narrow point, a girth of 12' 6" (3.81) was recorded.



Tree 3, middle of the trio, is a sturdy uniform looking tree with a bole rising about 7' before numerous branches explode in all directions. In 2003 I recorded a girth of 13' 10" at 3'. In 2015 Paul Wood measured at what he considered to be the narrowest point, 2' above the ground on the church side, and recorded 14' 3" (4.34m)



Tree 4 had a girth of 9' 3" at 3' in 2003. In 2015 Paul Wood noted a small hollow beginning to appear on the south side at a height of about 5'. Measured at what seemed to be the tree's narrowest point at 6' 6" it was 8' round. At the narrowest point where limbs had been removed above a bulge on the west side of the tree, 11' 3" was recorded.

