

In 1991 Hatton Gardner recorded that in Winforton churchyard were 'three yews with long trunks'. The yews are all found on the south side of the church in a churchyard that also contains several smaller girthed specimens.

Each of the yews recorded here are classified as veteran, two because of their girth, the third because of its condition.

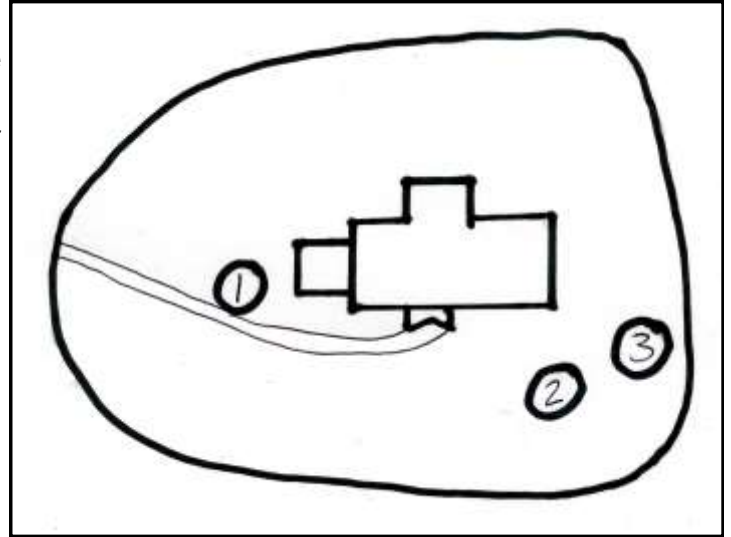

It is impossible not to be aware of yew 1, growing so close to the tower and with its roots encroaching on the main path that leads to and from the south porch. A crack (A) in the old dead sapwood on its west side reveals that the tree is hollowing. A considerable number of branches below a height of about 20ft have been removed because of its proximity to the path and church, resulting in an open and attractive bole. The lowest meaningful measurement was at about 1m, a height marked by a nail that somebody has hammered into the tree - at this height girth was 16' 2", while at 5' a girth of 17' 5" was recorded.



Yews 2 and 3 grow in a part of the churchyard that probably becomes overgrown later in the year. The yew numbered 2 on the plan appears solid, but there are gaps in its thickly fluted bole where hollowing is taking place. Bole height of this yew was about 12ft, above which numerous branches develop. The following girths were recorded:

16' 3" between 1' and 1' 6"

16' 3½ at 3' - the height of two nails

17' 6½ at 5'



Tree 3 might be the smallest girthed, but is already becoming hollow, with internal stems visible in some of the spaces. The holes are high in the tree so the old heartwood is yet to spill out. On the west side of the tree is a section of dead sapwood which will eventually decay and leave a space to the tree's interior. The yew's slender hollow stem rises to a great height. Girth was 14' 6½ at 2', where a nail had been hammered into the tree, and 14' 8½ at 3'.

